

Product Brief: Powereta™ – Single Output High Current Double-P Quarter Brick

Powereta™ iQP Series Double-P Quarter Brick 48V Input, 12V/25A/300W DC Output

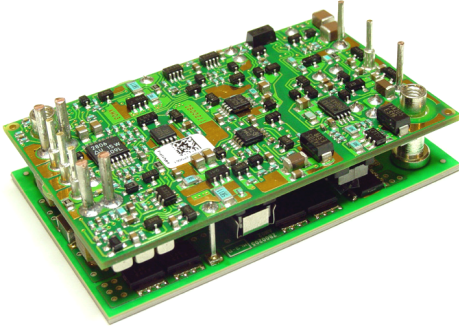

The Powereta™ iQP Series offers an industry standard Double-P quarter brick high current power module with true useable output power. The iQP series power modules are ideally suited for high-density distributed power architectures where the demands of voltage and substantial load mandate the creation of a robust local intermediate 12Vdc distribution bus. Its 91.5% full load efficiency (92.5% at 70% load) and superior thermal performance make the iQP Series of power modules ideally suited for tight space and power-hungry applications in demanding thermal environments. This rugged building block is designed to serve as the core of your high reliability system. A wide output voltage trim range, -20 to +10%, and remote sensing are standard

Features

- Standard Double-P Quarter Brick Pinout
- Size: 2.28" × 1.45" × 0.5"
- Up to 25A of output current
- Power density > 181W / in³
- Maximum efficiency – up to 94%
- Typical full load efficiency: 91.5%
- Output power – up to 300W in high ambient temperature, low airflow environments with minimal derating
- Wide output voltage trim range
- Industry standard output voltage trim
- Basic insulation – 1500Vdc
- Choice of remote on/off configuration
- Remote sense
- Constant switching frequency
- Latched output over-voltage protection
- Auto-recovery full protections:
 - Input under and over voltage
 - Output over-current
 - Output short circuit
 - Thermal limit
- UL 60950 (US and Canada), VDE 0805, CB scheme (IEC950) Safety markings and CE Mark (EN60950)
- Optional 0.110", 0.145", 0.180" pin length
- Optional non-latching OVP protection
- EMI: CISPR 22 A or B with external filter
- Multiple patents pending
- ISO9000 certified manufacturing facilities

TDK Innoveta Base Product Code	Input Voltage	Output Voltage	Output Current	Efficiency 70%Load	Efficiency 100%Load
iQP48025A120V	36-75V	12V	25A	92.5%	91.5%
iQP48021A120V	36-75V	12V	21A	92.5%	92%

Typical Performance

Input Characteristics		
Operating input range	36-75V	
Transient input voltage	100V	100mS max
Turn-on voltage	34.7V	
Turn-off voltage	32.3V	
Maximum input current	10.5A	Input 0-75V, I _{o,max}
Output Characteristics		
Output voltage tolerance	+/- 3.3% max	Over line, load, and temp to end of life
Efficiency	91.5%	I _{o,max}
Line regulation	3 mV	Over rated input
Load regulation	3 mV	Over rated load
Start-up time	40 ms	On/Off to 90% V _o
Output voltage adjustment	80%-110%	%V _{o,nom}
Output ripple	85 mVp-p	20MHz bandwidth
Dynamic response	Load step 25% of I _{o,max}	
Transient voltage	90 mV	
Recovery time	200 μS	slew rate =0.1A/us
Ripple frequency	250 kHz	Fixed
Protection		
Output over-current	108% of I _{o,rated}	Auto-recovery hiccup
Short circuit	Continuous protection	Auto-recovery hiccup
Output over-voltage	121% of V _{out,nom}	Latching
Thermal shutdown	126C	Auto recovery with hysteresis
Environmental		
Operating temperature, T _c	-40C to 111C	See full datasheet

Product Brief: Powereta™ – Single Output High Current Double-P Quarter Brick

Dimensions are in mm [in]. Unless otherwise specified tolerances are: $x.x \pm 0.5$ [0.02], $x.xx \pm 0.25$ [0.010].

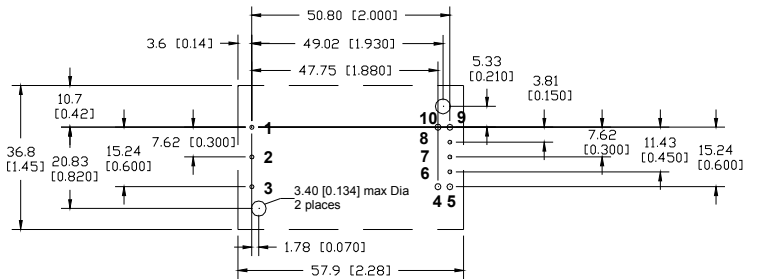
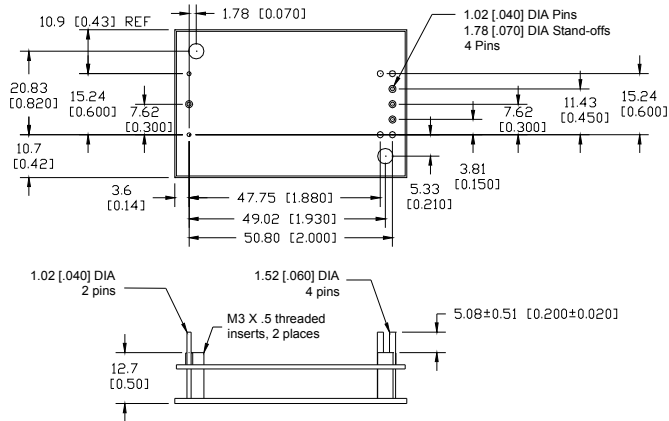

Recommended hole pattern (top view)

PIN	FUNCTION	PIN	FUNCTION
1	Vin (+)	4	Vo (-)
2	On/Off	5	Vo (-)
3	Vin (-)	6	Sense (-)
		7	Trim
		8	Sense (+)
		9	Vout (+)
		10	Vout (+)

Ordering Information

Product Identifier	Package Size	Platform	Input Voltage	Output Current/Power	Output Units	Main Output Voltage	# of Outputs	Safety Class	Feature Set
I	Q	P	48	025	A	120	V	- 0	05
TDK Innoveta	Quarter-Brick	Double-P	36-75V	025 – 25A 021 – 21A	Amps	120 – 12V	Single		05 – Standard

Feature Set	On/Off Logic	OVP	Pin Length
00	Positive	Latch	0.145"
01	Negative	Latch	0.145"
02	Positive	Latch	0.110"
03	Negative	Latch	0.110"
04	Positive	Latch	0.200"
05	Negative	Latch	0.200"
06	Positive	Non-Latch	0.145"
07	Negative	Non-Latch	0.145"
08	Positive	Latch	0.180"
09	Negative	Latch	0.180"

TDK Innoveta Inc.

3320 Matrix Drive, Suite 100
Richardson, Texas 75082

Phone (877) 498-0099 Toll Free
(469) 916-4747

Fax (877) 498-0143 Toll Free
(214) 239-3101

support@tdkinnoveta.com
<http://www.tdkinnoveta.com/>

Information furnished by TDK Innoveta is believed to be accurate and reliable. However, TDK Innoveta assumes no responsibility for its use, nor for any infringement of patents or other rights of third parties, which may result from its use. No license is granted by implication or otherwise under any patent or patent rights of TDK Innoveta. TDK Innoveta components are not designed to be used in applications, such as life support systems, wherein failure or malfunction could result in injury or death. All sales are subject to TDK Innoveta's Terms and Conditions of Sale, which are available upon request. Specifications are subject to change.